

# Introduction

When the charging station and the boundary wire are completely installed and the Automower™ is linked to the charging station, the mower can be started.

This document is a quick guide to installing the Automower. There is more information about the mower and the installation in the Automower Operator's Manual.

## Parts of the Automower

1. Display
2. Control panel
3. Main switch
4. Contact strips
5. LED for operation check of the boundary wire
6. STOP button
7. Catch button for opening the cutting height adjustment cover
8. Charging strips

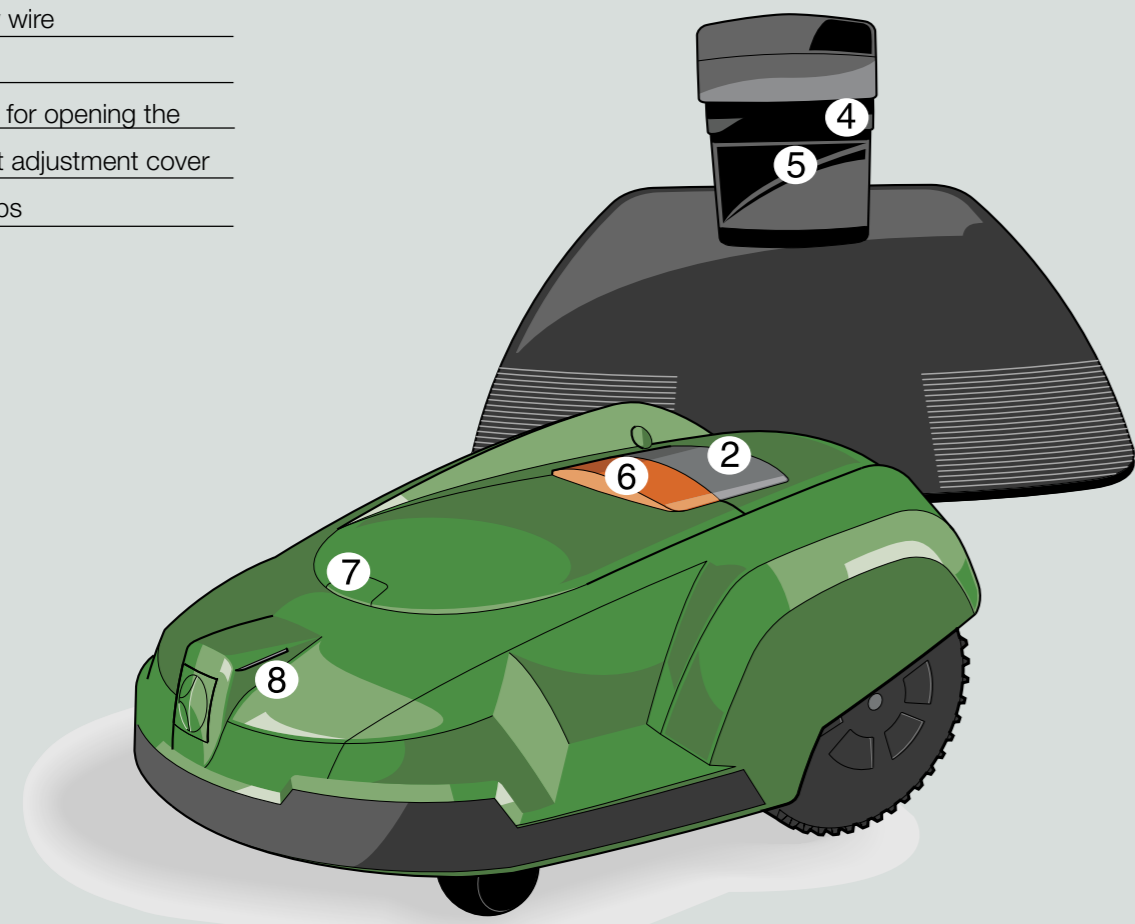
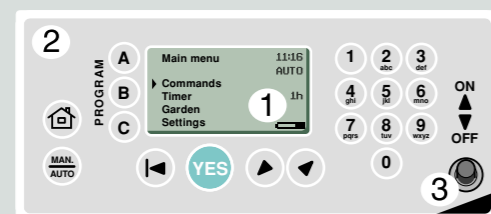

[www.automower.com](http://www.automower.com)

**The Electrolux Group. The world's No.1 choice.**

The Electrolux Group is the world's largest producer of powered appliances for kitchen, cleaning and outdoor use. More than 55 million Electrolux Group products (such as refrigerators, cookers, washing machines, vacuum cleaners, chain saws and lawn mowers) are sold each year to a value of approximately USD 14 billion in more than 150 countries around the world.

[www.electrolux.com](http://www.electrolux.com)

Automower™ is a trademark of the Electrolux Group.

The Automower is protected by several patents.

EP 0 550 473	EP 1 025 472	US 6.300.737
EP 1 058 958	EP 1 302 147	US 6.525.509
US 6.586.908	SE 511 254	US 6.465.982



# Get started

A quick guide to how to install the Automower™.

If you feel uncertain about any step of the installation, check the Operator's manual.

## Make sure you have all the components:

- A. Automower
- B. Charging station
- C. Transformer
- D. Low voltage cable, transformer connector
- E. Boundary wire and splice kit, if the boundary wire needs to be spliced.
- F. Staples and/or a spade. A hammer is useful for stapling.
- G. Boundary wire connector
- H. Pliers

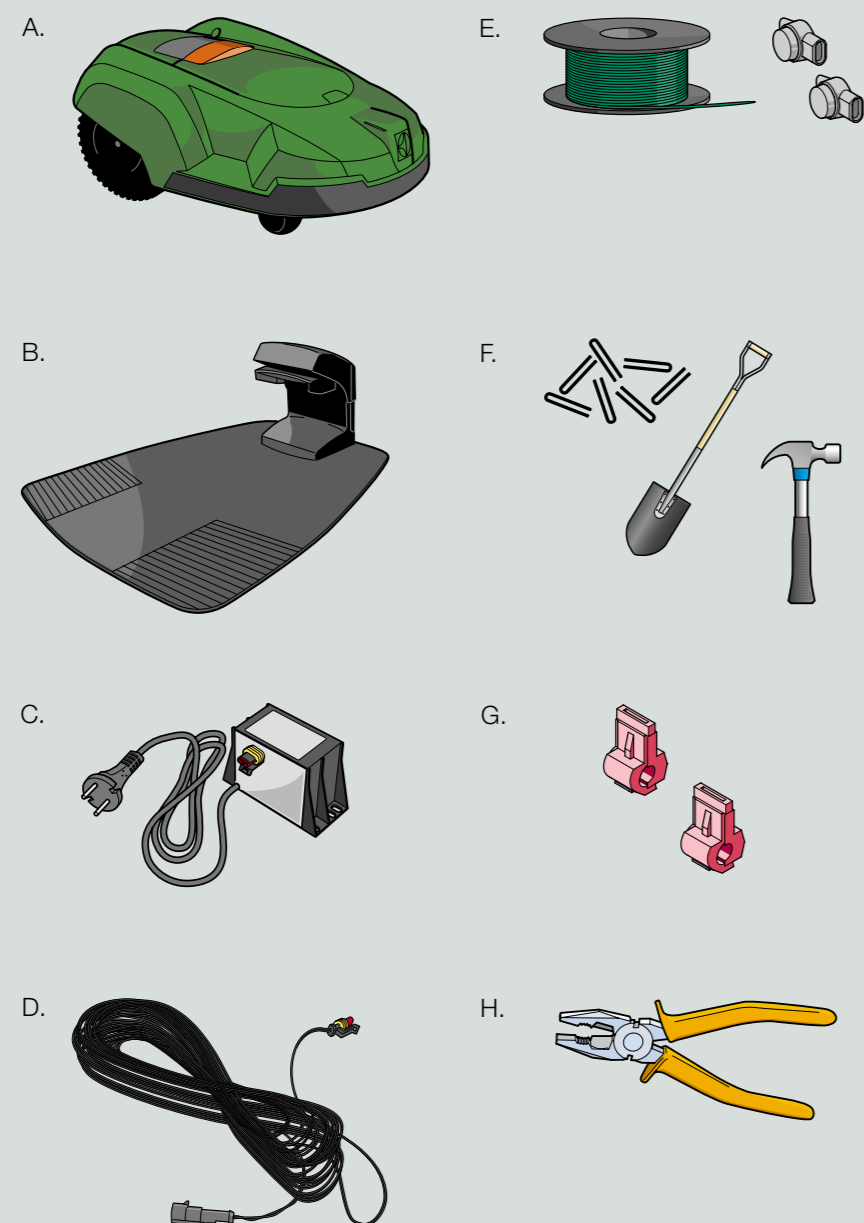

## 1

### Placing and connecting the charging station

- Place the charging station centrally in the working area, with a large free area in front of the station and on level ground.
- Connect the low voltage cable to the charging station and the transformer.
- Connect the transformer's power cord to a 230V wall socket.

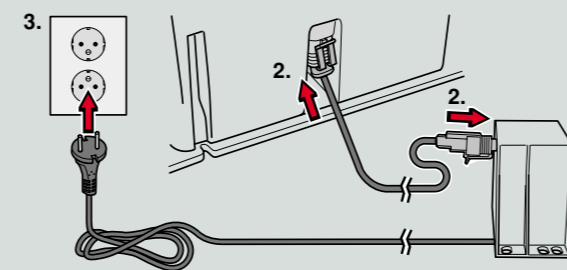

## 2

### Charging the battery and laying out the boundary wire

- Place the Automower™ in the charging station to charge the battery while you are laying out the boundary wire. Leave the main switch in the OFF position.
- Lay out the boundary wire so it forms a loop around the working area.

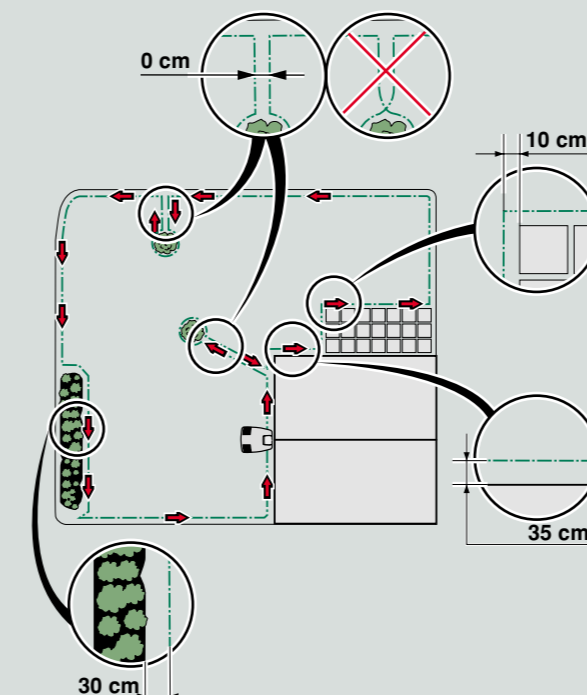

## 3

### Connecting the boundary wire

- Lift off the cover on the charging station and slide in the ends of the boundary wire in the lowermost holes on the charging station and catch them in the uppermost holes:
  - Right hand wire end into the right hand hole.
  - Left hand wire end into the left hand hole.
- Open the connector and place the wire in the connector grip.
- Press the connector together using a pair of pliers.
- Cut off any surplus boundary wire. Cut 1-2 cm above the connector.
- Press the connector onto the metal pin on the charging station. Refit the cover on the charging station.

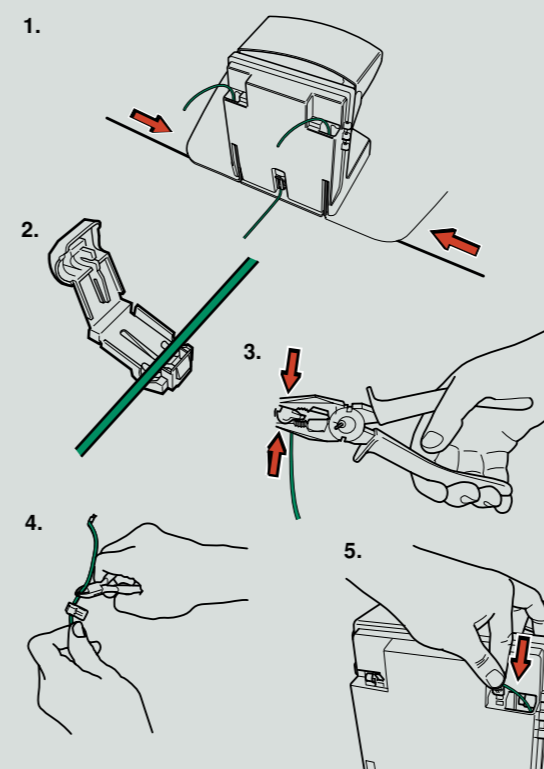

## 4

### Checking the installation

Check the loop signal by looking to see what indication the green LED on the charging station is giving.

- Lit = the signal is okay.
- Single flashing every other second = break in the loop and no signal found.
- Double flashing every other second = signal found, but the wire is probably damaged.

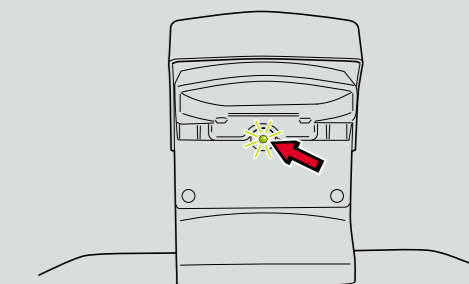

## 5

### Linking the Automower™ to the charging station

To be fully functional, the Automower must be linked to its charging station.

- Make sure the Automower is in the charging station.
- Enter, when requested: Language, time format, time, date format, and date.
- Choose and enter a four digit PIN code.

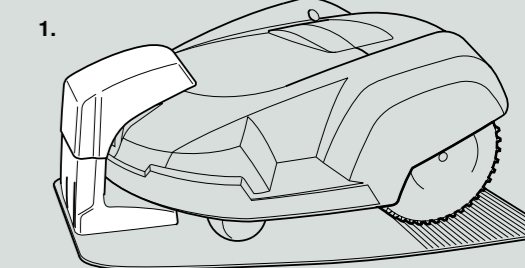

## 6

### Starting and stopping the Automower

#### Starting

- Open the control panel cover by pressing the STOP button.
- Set the main switch to the ON position.
- Close the cover.

#### Stopping

Press the STOP button.

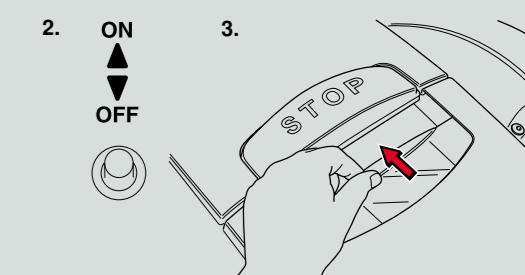

## 7

### Menu functions

You manage all the mower settings via the menu functions. Via the main menu and its submenus, you customise the behaviour of the mower with the help of functions like timer, sounds, and security. For a complete description of the menu functions, see the Operator's manual for Automower.

#### The timer function

To achieve a good lawn quality and to avoid the lawn being trodden, it is recommended to use the timer function (select "Timer" on the main menu). By setting what time and which days to mow, you ensure that Automower mows only as much as necessary. When setting the timer, consider that the Automower mows about 75 m<sup>2</sup> per hour.

#### Security

As a precaution against theft, it is recommended to use the time lock function (select "Settings" on the main menu and "Security" on the following submenu). The time lock function involves the Automower stopping after a predetermined number of days and not continuing until the correct PIN code has been entered.

